

WALWORTH COUNTY
SURVEYING & MAPPING
LAKE GENEVA, WISCONSIN

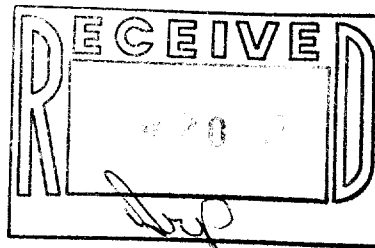

WEST WAUBUN DRIVE
30' WIDE

(105.3')
105.16
(2°40' CURVE)

ELECTRIC DRIVEWAY

27

29

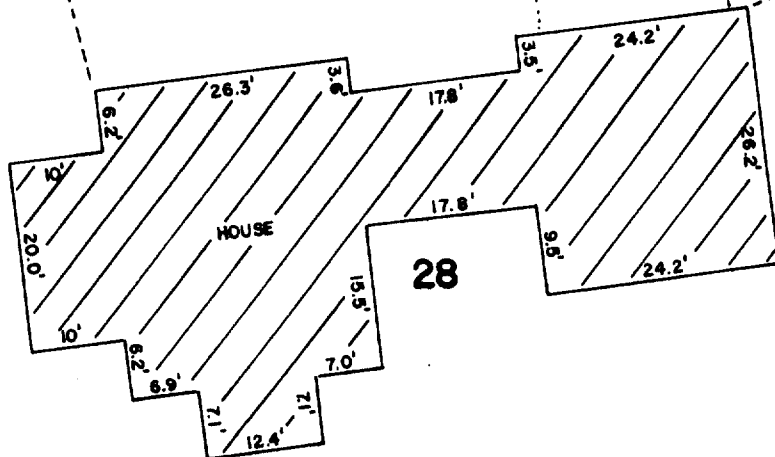

ORDERED BY:
COLDWELL BANKER
GENEVA LAKES AREA
REALTORS
838 MAIN STREET
LAKE GENEVA, WISCONSIN
53147

45

46

PLAT OF SURVEY OF

LOT 28 OF COUNTRY CLUB ESTATES UNIT
NO. 2, LOCATED IN THE VILLAGE OF
FONTANA-ON-GENEVA LAKE, WALWORTH
COUNTY, WISCONSIN.

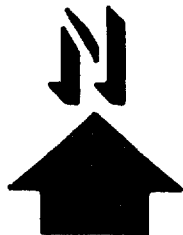

SCALE: 1"=20'

• - CONCRETE MONUMENT FOUND
ø - IRON ROD FOUND
() - RECORDED AS

I, ROBERT M. BAERENWALD, DO HEREBY CERTIFY THAT I
HAVE SURVEYED THE PROPERTY HEREON DESCRIBED ACCORDING
TO THE OFFICIAL RECORDS AND THAT THE PLAT HEREON IS A
CORRECT REPRESENTATION OF THE PROPERTY LINES TO THE
BEST OF MY KNOWLEDGE AND BELIEF.

Robert M. Baerenwald
ROBERT M. BAERENWALD
WISCONSIN REGISTERED LAND SURVEYOR, S-1508

April 3, 1987
DATE JOB NO. 0975

NOTE: THIS IS NOT A CERTIFIED COPY UNLESS SEALED.

SC02-25

5-707